

EXISTING RUNWAY 8 TRAVERSE WAY TABLE VISUAL APPROACH (20:1 SLOPE)					
ID	DESCRIPTION	TRAVERSE WAY ELEVATION	TRAVERSE WAY ELEVATION + (FAR) PART 77 CLEARANCE REQUIREMENTS	EXISTING PENETRATION	DISPOSITION
T9	ROAD	83.0'	98.0'	-34.7'	NONE
T10	ROAD	84.0'	99.0'	-33.2'	NONE
T11	ROAD	84.0'	99.0'	-33.1'	NONE
T12	ROAD	85.0'	100.0'	-32.7'	NONE
T13	ROAD	85.0'	100.0'	-32.9'	NONE

FUTURE RUNWAY 9 TRAVERSE WAY TABLE NPI APPROACH (34:1 SLOPE)					
ID	DESCRIPTION	TRAVERSE WAY ELEVATION	TRAVERSE WAY ELEVATION + (FAR) PART 77 CLEARANCE REQUIREMENTS	FUTURE PENETRATION	DISPOSITION
T10	ROAD	84.0'	99.0'	12.1'	OBST. LIGHT
T11	ROAD	84.0'	99.0'	12.1'	OBST. LIGHT
T12	ROAD	85.0'	100.0'	12.7'	OBST. LIGHT
T13	ROAD	85.0'	100.0'	12.7'	OBST. LIGHT
T14	ROAD	84.0'	99.0'	10.5'	OBST. LIGHT

EXISTING RUNWAY 18 / FUTURE RUNWAY 19 END TRAVERSE WAY TABLE NPI APPROACH (34:1 SLOPE)						
ID	DESCRIPTION	TRAVERSE WAY ELEVATION	TRAVERSE WAY ELEVATION + (FAR) PART 77 CLEARANCE REQUIREMENTS	EXISTING PENETRATION	FUTURE PENETRATION	DISPOSITION
T6	ROAD	80.0'	95.0'	-58.2'	SAME	NONE
T7	ROAD	93.0'	108.0'	-45.0'	SAME	NONE
T8	ROAD	90.0'	105.0'	-47.7'	SAME	NONE
T22	FUTURE ROAD	93.0'	108.0'	N/A	-22.7'	NONE
T23	FUTURE ROAD	94.2'	109.2'	N/A	-22.0'	NONE
T24	FUTURE ROAD	90.3'	105.3'	N/A	-25.9'	NONE

EXISTING RUNWAY 26 TRAVERSE WAY TABLE VISUAL APPROACH (20:1 SLOPE)					
ID	DESCRIPTION	TRAVERSE WAY ELEVATION	TRAVERSE WAY ELEVATION + (FAR) PART 77 CLEARANCE REQUIREMENTS	EXISTING PENETRATION	DISPOSITION
T15	ROAD	76.0'	91.0'	-39.6'	NONE
T16	ROAD	75.0'	90.0'	-42.9'	NONE
T17	ROAD	75.0'	90.0'	-42.4'	NONE
T18	ROAD	74.0'	89.0'	-43.9'	NONE
T19	ROAD	72.0'	87.0'	-47.1'	NONE
T20	ROAD	72.0'	87.0'	-47.4'	NONE

FUTURE RUNWAY 27 TRAVERSE WAY TABLE NPI APPROACH (34:1 SLOPE)					
ID	DESCRIPTION	TRAVERSE WAY ELEVATION	TRAVERSE WAY ELEVATION + (FAR) PART 77 CLEARANCE REQUIREMENTS	FUTURE PENETRATION	DISPOSITION
T16	ROAD	75.0'	90.0'	2.2'	OBST. LIGHT
T18	ROAD	74.0'	89.0'	1.1'	OBST. LIGHT
T19	ROAD	72.0'	87.0'	-1.6'	NONE
T20	ROAD	72.0'	87.0'	-1.8'	NONE
T21	ROAD	70.0'	85.0'	-5.0'	NONE

EXISTING RUNWAY 36 / FUTURE RUNWAY 1 END TRAVERSE WAY TABLE PI APPROACH (50:1 SLOPE)						
ID	DESCRIPTION	TRAVERSE WAY ELEVATION	TRAVERSE WAY ELEVATION + (FAR) PART 77 CLEARANCE REQUIREMENTS	EXISTING PENETRATION	FUTURE PENETRATION	DISPOSITION
T1	ROAD	72.0'	87.0'	-46.2'	N/A	NONE
T2	ROAD	72.0'	87.0'	-46.3'	-27.6'	NONE
T3	ROAD	75.0'	90.0'	-43.4'	-24.7'	NONE
T4	ROAD	82.0'	97.0'	-36.5'	-17.8'	NONE
T5	ROAD	82.0'	97.0'	-36.5'	N/A	NONE

NOTE: T1 & T5 FALL OUTSIDE OF APPROACH SURFACE AFTER RUNWAY IS EXTENDED.

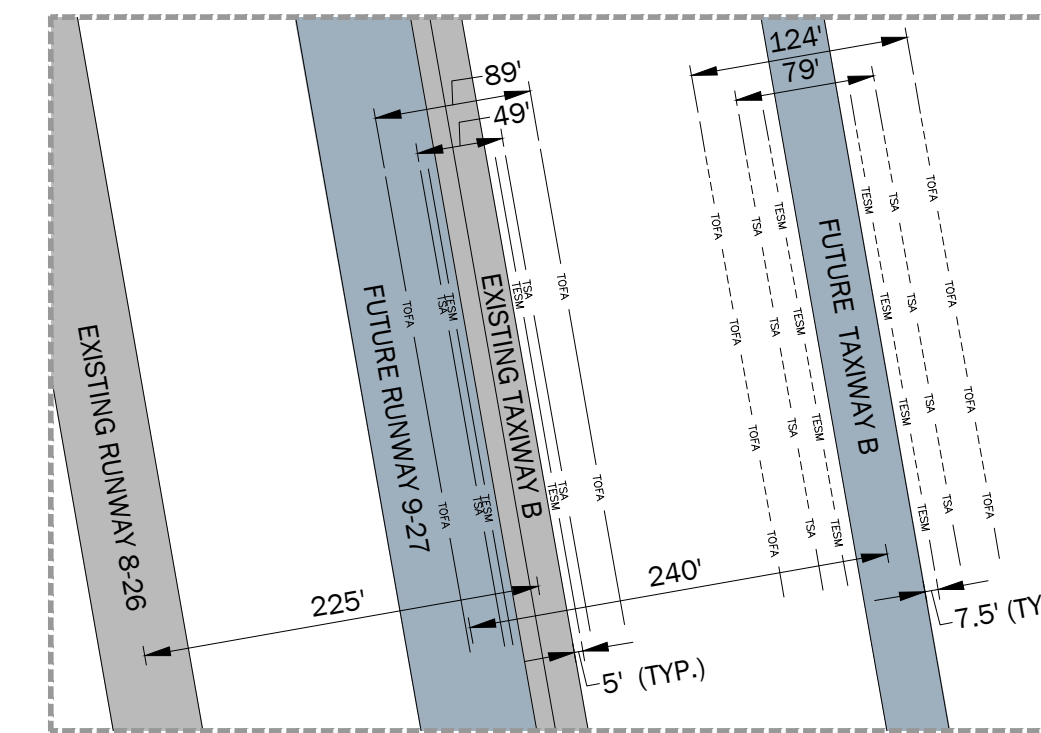

DESIGNER: APN
 CHECKED BY: RWO
 TECHNICIAN: APN
 PROJECT NUMBER: 23-017

- GENERAL NOTES:
- THE (NAVD83) VERTICAL CONTROL DATUM WAS USED FOR ALL ELEVATIONS.
 - THE (NAVD83) COORDINATE SYSTEM WAS USED FOR ALL LATITUDE AND LONGITUDE COORDINATES.
 - ALL ELEVATIONS SHOWN ARE ABOVE MEAN SEA LEVEL (AMSL) UNLESS OTHERWISE NOTED.
 - ALL TRAVERSE WAY CALCULATIONS REFERENCE FEDERAL AVIATION REGULATIONS (FAR) PART 77 WHICH SPECIFIES CLEARANCE REQUIREMENTS FOR ROADS, RAILROADS AND WATERWAYS AS FOLLOWS: A) 17 FEET FOR AN INTERSTATE HIGHWAY, B) 15 FEET FOR ANY OTHER PUBLIC ROADWAY, C) 10 FEET OR THE HEIGHT OF THE HIGHEST MOBILE OBJECT THAT WOULD NORMALLY TRAVERSE THE ROAD, D) 23 FEET FOR A RAILROAD, AND E) FOR A WATERWAY OR ANY OTHER TRAVERSE WAY NOT PREVIOUSLY MENTIONED, AN AMOUNT EQUAL TO THE HEIGHT OF THE HIGHEST MOBILE OBJECT THAT WOULD NORMALLY TRAVERSE IT.
 - EXISTING FENCE HEIGHT IS APPROXIMATELY 6' TALL. IT IS RECOMMENDED THAT FUTURE FENCING IS 7' TALL WITH 1" OF 3 STRAND BARB WIRE PER AC 150/5300-136, SECTION 6.8.2.1.
- PLAN REFERENCED NOTES:
- THE BUILDING RESTRICTION LINE (BRL) HAS BEEN ESTABLISHED TO REMAIN BEYOND AND CLEAR OF ALL RUNWAY PROTECTION ZONES (RPZ), OBSTACLE FREE ZONES (OFZ), OBJECT FREE AREAS (OFAS), SAFETY AREAS, NAVIAD CRITICAL AREAS AND ATCT CLEAR LINE OF SIGHT (LOS).
 - RUNWAY / HOLDING POSITION MARKING SEPARATION DISTANCES ARE AS FOLLOWS: EXISTING 18-36 / FUTURE 1-15 = 250' EXISTING 8-26 = 125' FUTURE 9-27 = 200'
 - ONLY A SAMPLE OF TAXIWAY EDGE SAFETY MARGIN (TESM) LINEWORK HAS BEEN SHOWN FOR EXISTING AND FUTURE TAXIWAY B. (SEE DETAIL A THIS SHEET) FOR THE PURPOSE OF CLARITY. THE TESM LINEWORK FOR EXISTING TAXIWAY A AND FUTURE TAXIWAY C HAS NOT BEEN SHOWN. THE TESM FOR TAXIWAY A IS 7.5' FROM EDGE OF PAVEMENT AND THE TESM FOR TAXIWAY C IS 14' FROM EDGE OF PAVEMENT.

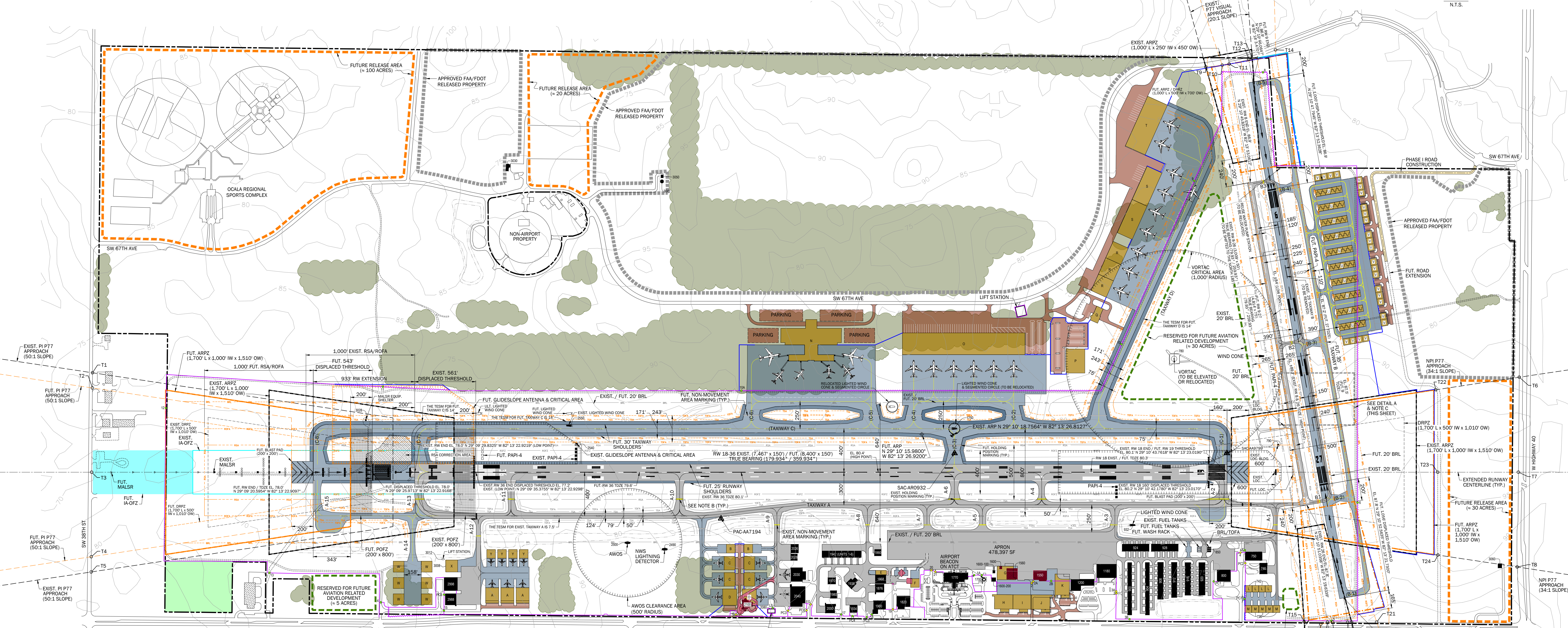

DRAFT

GATE TABLE		
ID	DESCRIPTION	GATE TYPE
1	ATCT VEHICLE ACCESS TO ADA	MANUAL
1A	ATCT PEDESTRIAN	MANUAL
2	SHELTAIR HANGAR CAMPUS GATE	ELECTRIC/CARD READER
2A	SHELTAIR HANGAR CAMPUS PEDESTRIAN SOUTH	ELECTRIC/CARD READER
2B	SHELTAIR HANGAR CAMPUS PEDESTRIAN NORTH	MANUAL
3	T-HANGAR ACCESS GATE	ELECTRIC/CARD READER
3A	T-HANGAR ACCESS PEDESTRIAN	ELECTRIC/CARD READER
3B	T-HANGAR PEDESTRIAN GATE TO SW 67TH AVE	MANUAL
PC1	PRIVATE VEHICLE GATE MAINTENANCE FACILITY NORTH GATE	ELECTRIC/CARD READER
4	NORTH PEDESTRIAN GATE	MANUAL
PC2	PRIVATE VEHICLE GATE	ELECTRIC/CARD READER
5	PRIVATE AEROPLEX GATE	MANUAL
6	VEHICLE ACCESS EAST PERIMETER FENCE TO SW 60TH AVE	MANUAL
7	VEHICLE ACCESS NORTHEAST PERIMETER FENCE	MANUAL
7A	VEHICLE ACCESS NORTH PERIMETER FENCE	MANUAL
8	VEHICLE ACCESS GATE NORTHWEST CORNER TO SW 67TH AVE	MANUAL
9	VEHICLE ACCESS GATE	MANUAL
10	VEHICLE ACCESS GATE TO VORTAC AREA	MANUAL
10A	VEHICLE ACCESS GATE WEST PERIMETER FENCE	MANUAL
11	VEHICLE ACCESS GATE TO WATER SEWER LIFT STATION	MANUAL
12	VEHICLE ACCESS TO SOUTH PERIMETER FENCE	MANUAL
13	VEHICLE ACCESS TO SOUTHEAST PERIMETER FENCE	MANUAL
14	VEHICLE ACCESS EAST PERIMETER FENCE TO SW 60TH AVE	MANUAL
PC6	PRIVATE VEHICLE GATE A12 HANGAR	MANUAL
15	VEHICLE ACCESS TO A12 APRON	MANUAL
16	VEHICLE ACCESS GATE TO HEX-APORT	ELECTRIC/CARD READER
LS	LIFT STATION ACCESS GATE	MANUAL
PC3	PRIVATE VEHICLE GATE CORPORATE HANGAR	ELECTRIC/CARD READER
PC8	PRIVATE VEHICLE GATE CORPORATE HANGAR	ELECTRIC/CARD READER
EG	EMERGENCY GATE (20TH STREET GATE)	ELECTRIC/CARD READER
17	VEHICLE ACCESS GATE CORPORATE HANGAR	MANUAL
PC4	PRIVATE VEHICLE GATE CORPORATE HANGAR	MANUAL
18	VEHICLE ACCESS GATE TO SW 60TH AVE	MANUAL
PC5	PRIVATE VEHICLE ACCESS GATE CORPORATE HANGAR	MANUAL
19	VEHICLE ACCESS GATE (MCSO AREA)	ELECTRIC/CARD READER
20	TERMINAL GATE	ELECTRIC/CARD READER
21	TERMINAL PEDESTRIAN GATE	ELECTRIC/CARD READER

EXISTING BUILDING TABLE		
ID	DESCRIPTION	TOP EL. (AMSL)
746	BOX HANGAR (72'X100')	112
760	AIRPORT ADMINISTRATION/BOX HANGAR (82'X120')	116
800	BOX HANGAR (109'X124')	115
900	T-HANGARS (38'X482')	105
904	T-HANGARS (38'X482')	104
908	T-HANGARS (53'X340')	102
912	T-HANGARS (51'X323')	101
916	T-HANGARS (54'X300')	101
920	T-HANGARS (59'X300')	101
924	T-HANGARS (67'X247')	106
928	T-HANGARS (67'X247')	105
1180	FBO CORPORATE HANGAR	120
1200	FBO/BOX HANGAR (80'X105')	121
1550	OFFICE/BOX HANGAR (85'X125')	116
1560	BOX HANGAR (100'X100')	119
1600	SELF SERVE FUEL STATION	95
1600-100	STORAGE SHED	101
1600-200	ELECTRICAL VAULT	107
1700	AIR TRAFFIC CONTROL TOWER	182
1770	AIRPORT TERMINAL	110
1820	OFFICE	107
1860	BOX HANGAR (62'X62')	111
1868	BOX HANGAR (79'X102')	117
1876	BOX HANGAR (74'X82')	116
1900	OFFICE/BOX HANGAR (80'X114')	123
1934	BOX HANGAR (70'X70')	118
1938	OFFICE/BOX HANGAR (70'X70')	130
1942	CULLISON WRIGHT MIDFIELD HANGAR (UNITS 1-6)	110
1970	BOX HANGAR (62'X72')	117
1980	BOX HANGAR (60'X70')	119
2000	BOX HANGAR (82'X88')	118
2026	CORPORATE HANGAR	100
2028	CORPORATE HANGAR	100
2030	OFFICE/BOX HANGAR (108'X128')	119
2040	OFFICE/BOX HANGAR (140'X154')	119
2100	CONDO HANGAR	120
2988	CORPORATE HANGAR	110
2998	CORPORATE HANGAR	110
3030	COLLEGE CENTRAL FLORIDA LAW ENFORCEMENT TRAINING	110
3040	WRF #3 WATER TANK	142
3050	WRF #3 WATER TANK BUILDING	117
3060	DRIP FIELD PUMP HOUSE	105

FUTURE BUILDING TABLE		
ID	DESCRIPTION	TOP EL. (AMSL)
A	HANGAR (120'X140') (3)	110.0'
B	HANGAR (80'X80') (2)	105.0'
C	HANGAR (100'X125') (4)	120.0'
D	HANGAR (130'X150') (2)	125.0'
E	HANGAR (100'X140')	120.0'
F	HANGAR (80'X80')	110.0'
G	HANGAR (SHELTAIR)	121.0'
H	HANGAR (SHELTAIR)	121.0'
I	HANGAR (SHELTAIR)	121.0'
J	HANGAR (SHELTAIR)	121.0'
K	HANGAR (SHELTAIR)	123.0'
L	HANGAR (AEROPLEX) (4)	110.0'
M	HANGAR (AEROPLEX) (5)	110.0'
N	WEST SIDE TERMINAL	137.5'
O	AIR CARGO	150.0'
P	FAA & CUSTOMS	102.5'
Q	ARFF	100.0'
R	CARGO BUILDING (3)	115.0'
S	CARGO BUILDING (2)	115.0'
T	CARGO BUILDING	120.0'
U	T-HANGAR (10'LIMIT) (10)	105.0'
V	HANGAR (60'X60') (25)	115.0'
W	HANGAR (100'X100') (6)	110.0'
X	HANGAR (110'X110')	110.0'
Y	HANGAR (80'X80') (4)	110.0'

NOTE: BUILDING TOP ELEVATIONS SHOWN, WERE CALCULATED USING THE EXPECTED CONSTRUCTION HEIGHT ABOVE GROUND ELEVATION (AGL), PLUS THE AVERAGE ABOVE MEAN SEA LEVEL (AMSL) GROUND ELEVATION IN THE VICINITY.

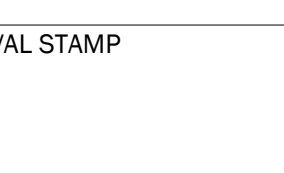
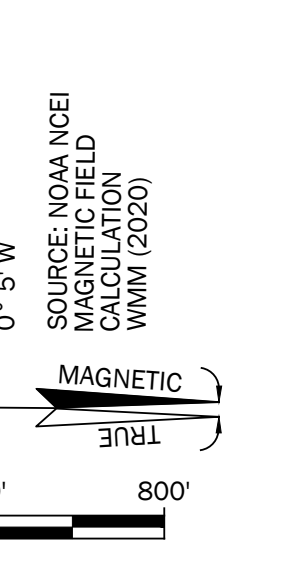

FAA APPROVAL STAMP

DESCRIPTION	LEGEND	
	EXISTING	FUTURE
AIRPORT PROPERTY LINE	---	---
FENCE (SEE NOTE 5)	---	---
FENCE (TO BE REMOVED)	N/A	---
ON-AIRPORT BUILDING	---	---
OFF-AIRPORT BUILDING	---	---
BUILDING OR PAVEMENT REMOVAL	N/A	---
AIRFIELD PAVEMENT	---	---
AIRFIELD PAVEMENT REMOVAL	N/A	---
RUNWAY MARKINGS	---	---
TAXIWAY CENTERLINE MARKINGS	---	---
ROAD / PARKING	---	---
UNPAVED ROAD	---	N/A
RSA	---	---
ROFA	---	---
ROFZ	---	---
ROFA/ROFZ	---	---
BRL	---	N/A
TSA	---	N/A
TOFA	---	N/A
MANUAL GATE	---	N/A
AUTOMATIC GATE	---	N/A
CONTOUR	---	N/A
DRAINAGE FEATURE	---	N/A
REQUESTED FAA RELEASE AREAS	---	N/A
TREES	---	N/A
INNER APPROACH-OFZ	---	---

REVISIONS			
NO.	DESCRIPTION	DATE	BY

AIRPORT LAYOUT PLAN PEN & INK UPDATE

AIRPORT LAYOUT PLAN DRAWING

PTGA FM450682-1-94-01

PLANNING

AUGUST 9, 2023

3